



Felton Way, Ely, CB6 1EB

CHEFFINS

Felton Way

Ely,
CB6 1EB

Semi-detached house overlooking green area. Accommodation comprises entrance porch, kitchen, lounge/diner, two bedrooms and shower room. Enclosed rear garden, garage and one parking space. Available: 06/02/2026. Deposit: £1,269. Holding fee: £253. Council tax band: B. EPC: C

LOCATION

Ely is an historic Cathedral City which provides an excellent range of shopping facilities, schools catering for all ages and various sporting and social activities including the recently opened Ely Leisure Village incorporating multi-screen cinema and restaurants. The main A10 road at Ely provides access to Cambridge which in turn links with the A14 and M11 motorway to London. Ely also has a mainline station which provides an electrified rail service to Cambridge and London.

2 1 1

£1,100 PCM



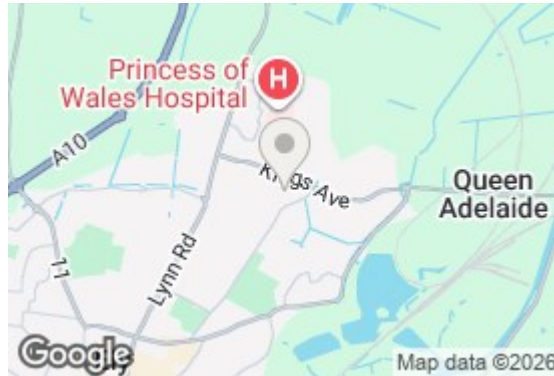

ENTRANCE PORCH

KITCHEN

with electric cooker, plumbing for washing machine, integrated fridge/freezer and dishwasher.

LIVING ROOM

with feature fireplace and laminate flooring.

BEDROOM

BEDROOM

with built-in cupboard.

SHOWER ROOM

with WC, hand basin, shower cubicle and built-in storage cupboard.

OUTSIDE

There is an enclosed rear garden that leads to a garage and parking space.

LETTING AGENTS NOTES

For more information on this property please refer to the Material Information brochure on our Website.

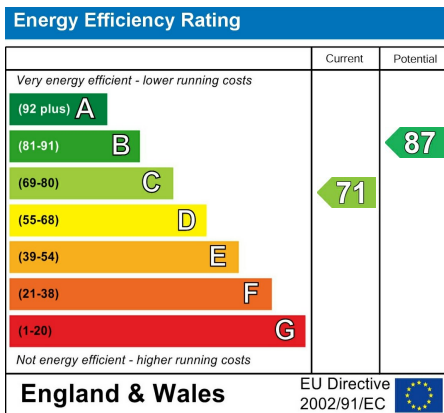

Ground Floor

Approx. 30.1 sq. metres (324.4 sq. feet)

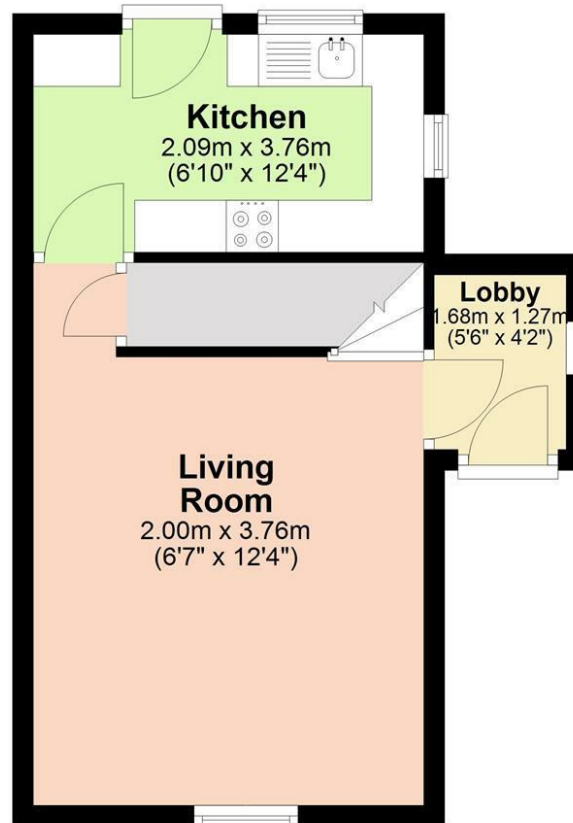

First Floor

Approx. 28.2 sq. metres (304.0 sq. feet)

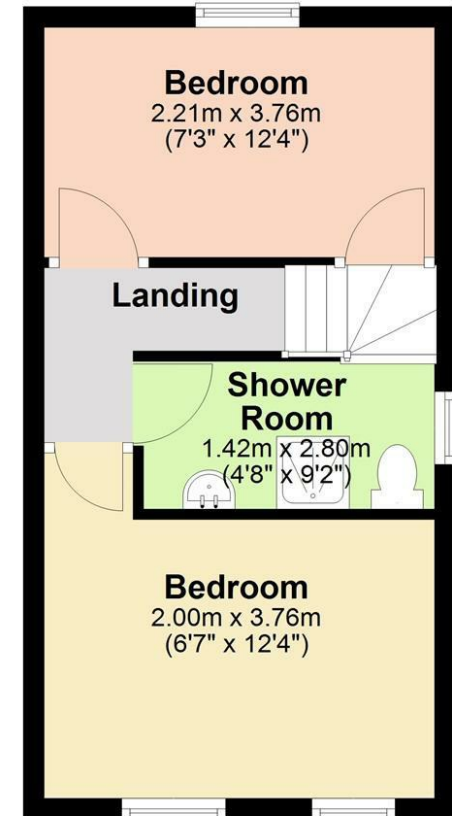

Total area: approx. 58.4 sq. metres (628.3 sq. feet)

Agents note:

For more information on this property please refer to the Material Information Brochure on our website.

25 Market Place, Ely, Cambridgeshire, CB7 4NP | 01353 663144 | cheffins.co.uk

IMPORTANT: we would like to inform prospective purchasers that these sales particulars have been prepared as a general guide only. A detailed survey has not been carried out, nor the services, appliances and fittings tested. Room sizes should not be relied upon for furnishing purposes and are approximate. If floor plans are included, they are for guidance only and illustration purposes only and may not be to scale. If there are any important matters likely to affect your decision to buy, please contact us before viewing the property.



CHEFFINS